

TECHNICAL REFERENCE DRAWING

BALUSTER (1.25" X 1.25")

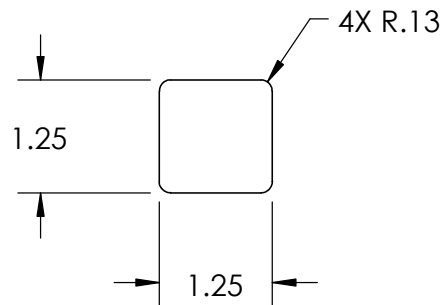
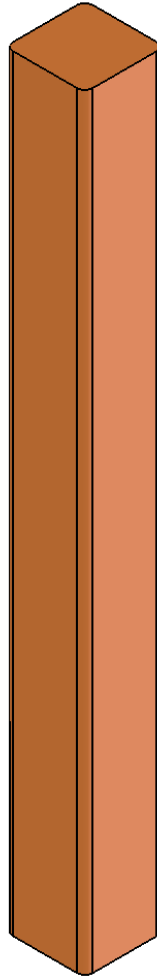

BALUSTER 1.25" X 1.25" STANDARD LENGTHS	
PART NUMBER	LENGTH
NC-600-04	4 FEET
NC-600-08	8 FEET
ADDITIONAL LENGTHS AVAILABLE UPON REQUEST	

PHYSICAL PROPERTIES
 MASS = 0.67 LBS/LINEAR FOOT
 CROSS SECTIONAL AREA = 1.55 IN²

PROPRIETARY AND CONFIDENTIAL
 THE INFORMATION CONTAINED IN THIS DRAWING IS THE SOLE PROPERTY OF NATURES COMPOSITES. ANY REPRODUCTION IN PART OR AS A WHOLE WITHOUT THE WRITTEN PERMISSION OF NATURES COMPOSITES IS PROHIBITED.

PART NUMBER	NC-600
DESCRIPTION	BALUSTER (1.25" X 1.25")
DRAWN BY:	JTM
DATE:	04/30/2014



NATURES COMPOSITES™

ORGANIC BUILDING PRODUCTS
 1302 INDUSTRIAL PARK AVE.
 TORRINGTON, WYOMING 82240
 (307) 532-9942

WWW.NATURESCOMPOSITES.COM