

# TECHNICAL REFERENCE DRAWING

## HOLLOW RAIL

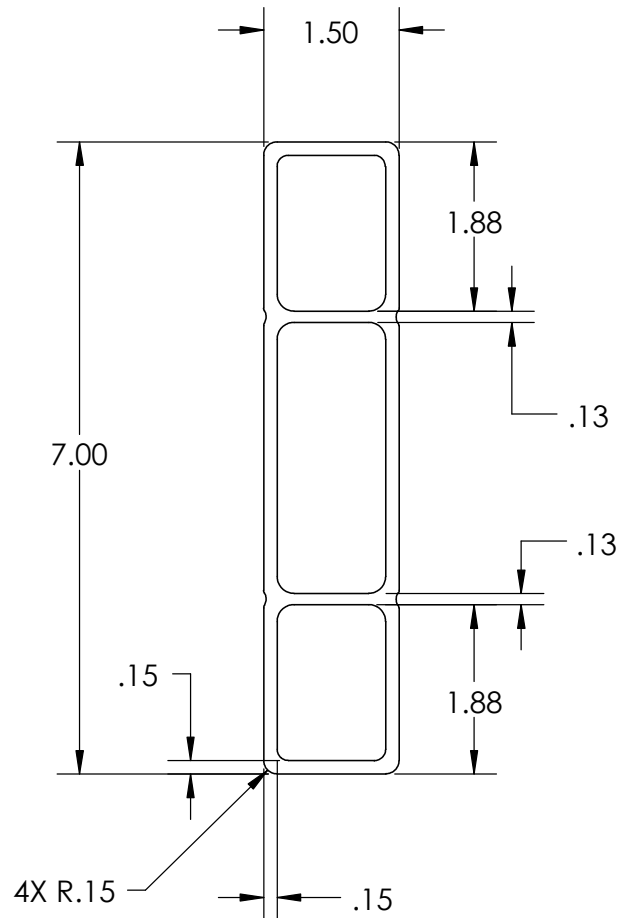
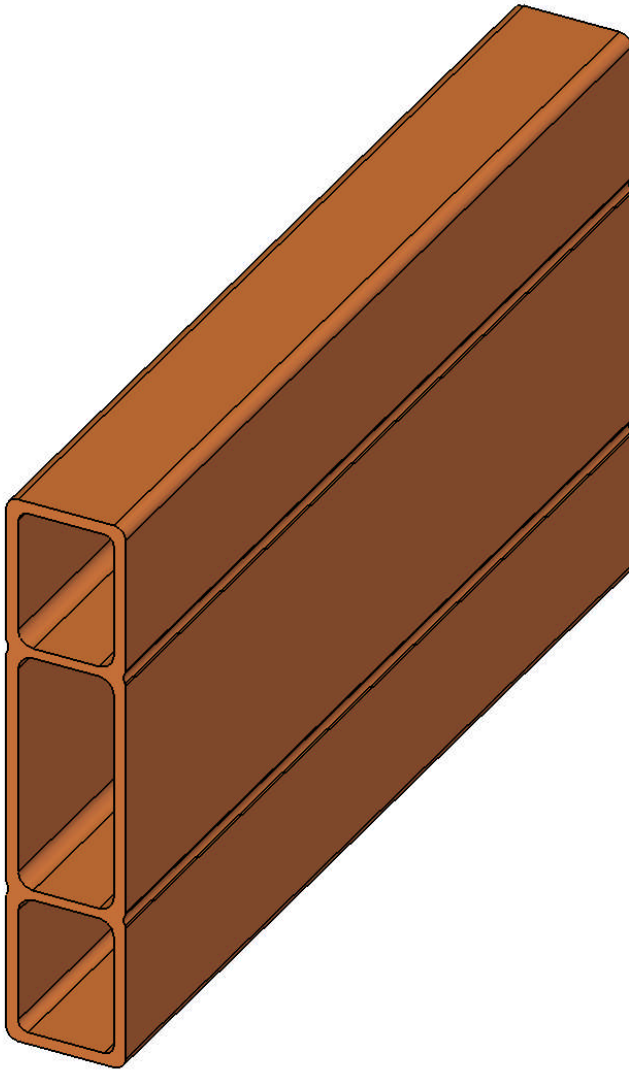

### HOLLOW RAIL STANDARD LENGTHS

PART NUMBER	LENGTH
NC-270-06	6 FEET
NC-270-08	8 FEET

ADDITIONAL LENGTHS AVAILABLE UPON REQUEST

### PHYSICAL PROPERTIES

MASS = 1.35 LBS/LINEAR FOOT  
CROSS SECTIONAL AREA = 2.80 IN<sup>2</sup>

**PROPRIETARY AND  
CONFIDENTIAL**

THE INFORMATION CONTAINED IN THIS DRAWING IS THE SOLE PROPERTY OF NATURES COMPOSITES. ANY REPRODUCTION IN PART OR AS A WHOLE WITHOUT THE WRITTEN PERMISSION OF NATURES COMPOSITES IS PROHIBITED.

PART NUMBER	NC-270
DESCRIPTION	HOLLOW RAIL
DRAWN BY: JTM	DATE: 04/23/2014



**NATURES COMPOSITES™**

ORGANIC BUILDING PRODUCTS  
1302 INDUSTRIAL PARK AVE.  
TORRINGTON, WYOMING 82240  
(307) 532-9942

[WWW.NATURESCOMPOSITES.COM](http://WWW.NATURESCOMPOSITES.COM)